



**LPM**  
USA

Low Pressure Molding  
Solutions from Design  
to Production

# KAPPA 1100H

Horizontal Injection Single Work Station  
with Built-In Tank

- ◆ Air over oil hydraulic cylinder gives more clamping force for larger parts
- ◆ Compact design with 5 liter melting tank integrated into work station
- ◆ User-friendly interface, 7" touch screen with multi-language PLC
- ◆ Two thermal control zones for precise melt control
- ◆ Equipped with light curtain and dual palm actuators for operator safety
- ◆ Ejection system for easy part removal

## Dimensions

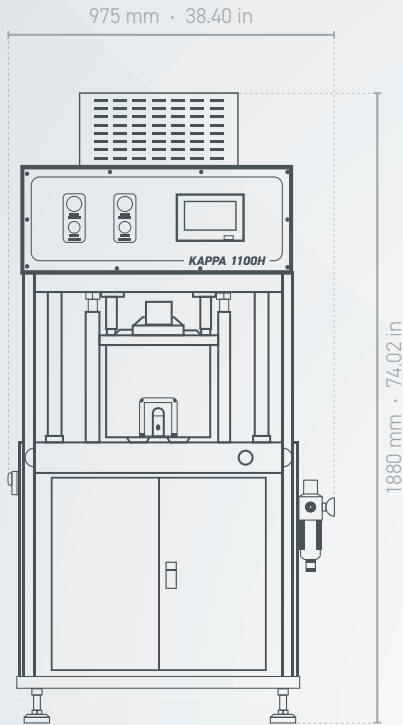

Machine

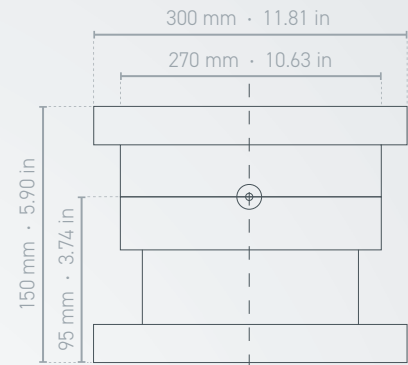
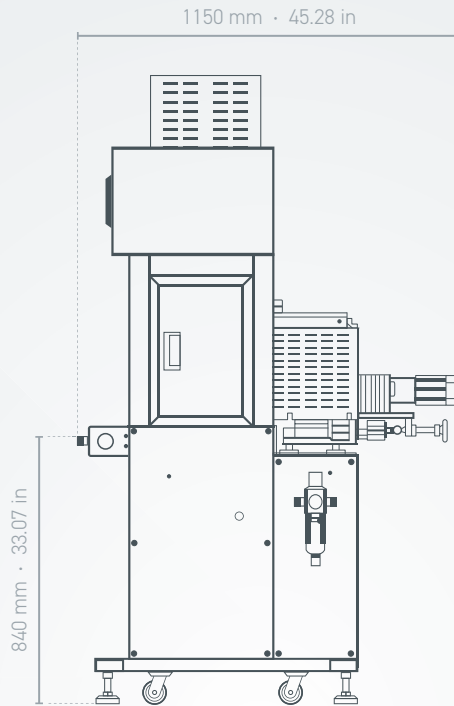

Mold Set

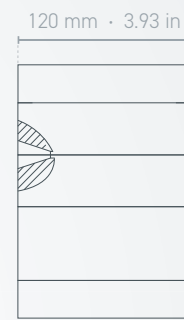

## Specifications

<b>Machine Size</b>	975 × 1150 × 1880 mm · 38.39 × 45.28 × 74.02 in · 882 lbs
<b>Electricity</b>	200–240 VAC · 1 Phase · 50 Hz
<b>Air Pressure</b>	0.5 MPa · 73 psi
<b>Air Volume</b>	3.5 ft <sup>3</sup> /min · 0.1 m <sup>3</sup> /min
<b>Autofeed</b>	Optional
<b>Clamping Method</b>	Air Over Oil cylinder
<b>Clamping Force</b>	5 Tons (10-Ton option)
<b>Clamping Stroke</b>	Max. 4.92 in (optional 5.91 in)
<b>Max. Mold Size</b>	300 × 200 × 150 mm · 11.81 × 7.87 × 5.90 in
<b>Nozzle</b>	LPMS-G02
<b>Standard Safety</b>	Light Curtain
<b>Temperature Control Zones</b>	2